

Subject: **Connect Your Entelar Inverter to New Wi-Fi Network**

Revision History

Version 2.0 - November 2024 - Initial release

Applicable products and models

EESOLAR Inverters

Follow the below steps to reconnect your Entelar inverter to your Wi-Fi network to access the monitoring features:

1. Download the HiSolar APP for recommissioning.

Android <https://play.google.com/store/apps/details?id=com.solar.pv>

IOS <https://apps.apple.com/us/app/hisolar/id6447599228>



2. Ensure that the inverter connects to the AC and DC power supplies at the same time. The running indicators are steady green or blink at long intervals for more than 3 minutes.

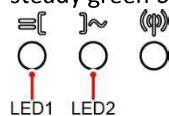

The communication indicator is off.

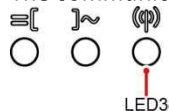

3. Standing next to the inverter, log in to the HiSolar App. Tap Manual Connection and select WLAN connection. Select the inverter WLAN hotspot as the Current WLAN. The name of the WLAN hotspot is the inverter serial number, and the password is 'Changeme' or check the label on the right-hand side of the inverter. Then, set up your user password. After login choose **Set > Communication configuration > Router connection settings** and set router parameters.

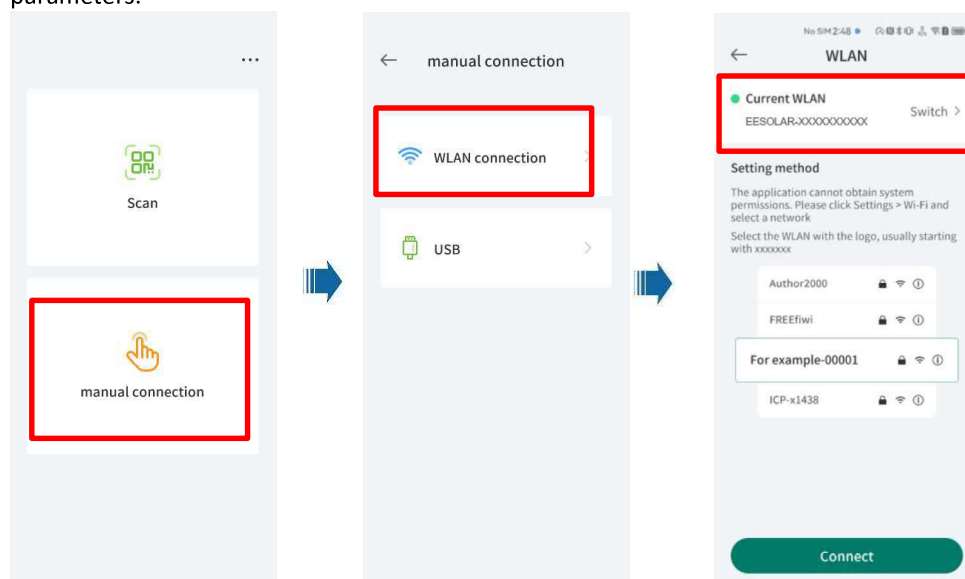

Switch the WLAN, if it is not connecting to the inverter WLAN hotspot.

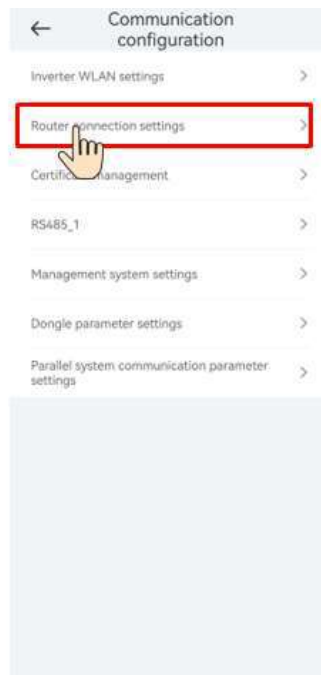
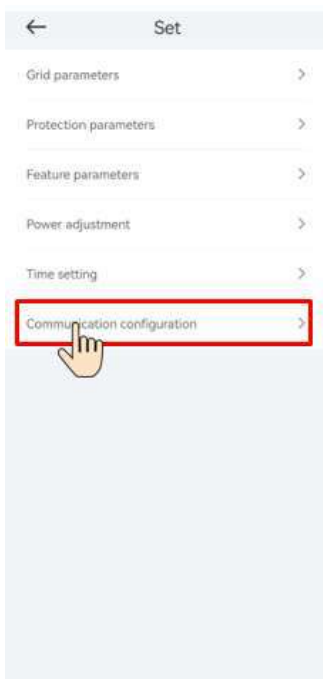
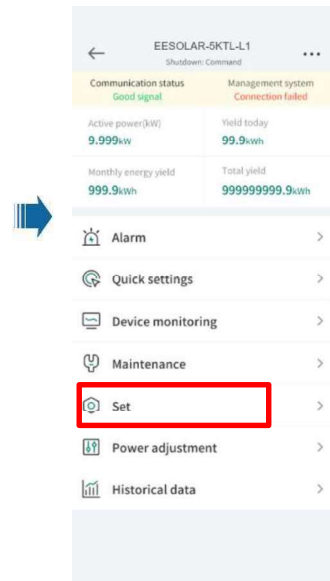
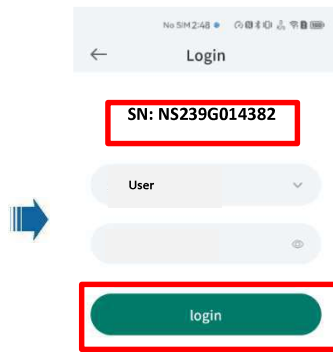

Update the Router connection setting to the current network provider. Wait for 5 minutes, the system will be back online on the Univers App.

-END-